

522 TAMMI DRIVE LEESBURG FL 34788

<https://candiscarmichael.com>

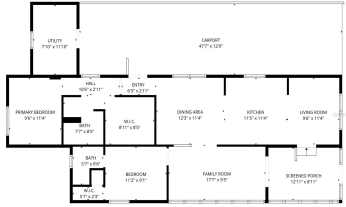

\$120,000



Welcome to this well-maintained 2-bedroom, 2-bath mobile home located in Leesburg within the desirable 55+ community of Bonfire Mobile Village. This home features laminate flooring throughout the main living areas, kitchen, and dining space, creating a clean and cohesive feel. The updated kitchen offers upgraded cabinetry along with stainless steel appliances including a refrigerator, range, [...]

- 2 beds
- 2 baths
- Residential
- Mobile Home
- Active
- 1078 sq ft



Courtesy of

Listing Office: EXP REALTY LLC

Status: Active

Office ID: MFR261010944

MLS ID: MFROM724355



Call us now

Phone: 727-888-3292
 Email: RealtorCandis@gmail.com



Description

Virtual Tour: <https://www.propertypanorama.com/instaview/stellar/OM724355>

Basics

Bathrooms Full: 2

Category: Mobile Home

Bedrooms: 2 beds

Half baths: 0 half baths

Lot size, sq ft: 313 sq ft

SubdivisionName: BONFIRE MOBILE HOME VILLAGE SUB

ListAOR: mfrmls

Date added: Added 3 hours ago

Type: Residential

Bathrooms: 2 baths

Area, sq ft: 1078 sq ft

Year built: 1971

ListOfficeName: EXP REALTY LLC

Location Details

Township: 19

Road Surface Type: Paved

Property Features

Interior Features: Ceiling Fans(s) **Appliances:** Dishwasher, Microwave, Range, Refrigerator

Flooring: Laminate

Laundry Features: Laundry Room, Outside

Carport YN: Yes

Carport Spaces: 2

Pets Allowed: Cats OK, Dogs OK

Exterior Features: Awning(s)

Roof: Metal

Utilities: Electricity Connected, Sewer Connected

Water Source: Public

Sewer: Public Sewer

Cooling: Central Air

Heating: Electric

Furnished: Unfurnished



Call us now

Phone: 727-888-3292

Email: RealtorCandis@gmail.com



Charles Rutenberg Realty, Inc.
THE STANDARD OF EXCELLENCE

Property Details

Subdivision Name: BONFIRE MOBILE HOME VILLAGE SUB

Levels: One

Foundation Details: Pillar/Post/Pier

Listing Terms: Cash

Parcel Number: 02-19-25-0015-000-52200

Direction Faces: Southeast

Construction Materials: Frame

Association Information

Association YN: Yes

Association Fee Frequency: Monthly

Community Features: Buyer Approval Required, Clubhouse, Community Mailbox

Association Fee: 170

Association Fee Includes: Common Area Taxes, Pool, Recreational Facilities, Sewer, Trash, Water

Fees&Taxes

Tax Year: 2025

Tax Legal Description: BONFIRE MOBILE HOME VILLAGE SUB UNIT 522 ORB 3124 PG 2283

Tax Annual Amount: \$1,000

Tax Lot: 522

Rooms



Call us now

Phone: 727-888-3292

Email: RealtorCandis@gmail.com



Charles Rutenberg Realty, Inc.
THE STANDARD OF EXCELLENCE

Room type	Dimensions	Level	Length	Width
Kitchen	11x11	First	11	11
Living Room	10x11	First	11	10
Family Room	18x10	First	10	18
Bedroom 1	11x9	First	9	11
Bathroom 1	6x6	First	6	6
Dining Room	12x12	First	12	12
Primary Bedroom		First		
Primary Bathroom	8x8	First	8	8

Amenities & Features

Waterfront available: No

AttachedGarageYN: No

PoolPrivateYN: No

CommunityFeatures: Buyer Approval Required, Clubhouse, Community Mailbox

Utilities: Electricity Connected, Sewer Connected

Amenities: Dishwasher, Microwave, Range, Refrigerator

GarageYN: No

FireplaceYN: No

Cooling: Central Air

ExteriorFeatures: Awning(s)

Features: Ceiling Fans(s)

Building Details



Call us now

Phone: 727-888-3292

Email: RealtorCandis@gmail.com



Charles Rutenberg Realty, Inc.
THE STANDARD OF EXCELLENCE

NewConstructionYN: No

Exterior material: Frame

Heating: Electric

Roof: Metal

Miscellaneous

Ownership: Co-op

Occupant Type: Vacant

Showing Requirements: ShowingTime



Call us now

Phone: 727-888-3292

Email: RealtorCandis@gmail.com



Charles Rutenberg Realty, Inc.
THE STANDARD OF EXCELLENCE