

175 1ST STREET ST PETERSBURG FL 33701

<https://candiscarmichael.com>

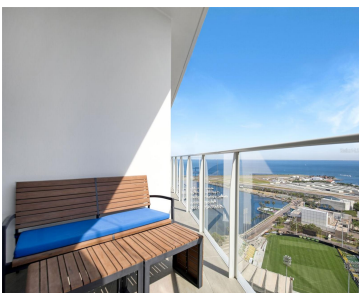

Rare opportunity to own one of the best units at Signature Place. This is one of only 4 “J” Estate Collection units built and offers a great floor plan and layout. 3rd bedroom is a den office. The large kitchen is outfitted with custom made cabinetry, granite counter tops, Thermador and Bosch appliances, wine cooler. The [...]

- 3 beds
- 3 baths
- Residential
- Condominium
- Active
- 2354 sq ft



Courtesy of

Listing Office: NORTHSTAR REALTY

Status: Active

Office ID: MFR283504594

MLS ID: MFRTB8425846



Call us now

Phone: 727-888-3292
Email: RealtorCandis@gmail.com



Description

Virtual Tour: <https://www.propertypanorama.com/instaview/stellar/TB8425846>

Basics

Unit Number: 3103

Bathrooms Half: 1

Category: Condominium

Bedrooms: 3 beds

Half baths: 1 half bath

Area, sq ft: 2354 sq ft

Year built: 2009

SubdivisionName: SIGNATURE PLACE CONDO

GarageSpaces: 2

Bathrooms Full: 2

Date added: Added 3 hours ago

Type: Residential

Bathrooms: 3 baths

Floors: 36 floors

Lot size, sq ft: 88604 sq ft

UnitNumber: 3103

ListOfficeName: NORTHSTAR REALTY

ListAOR: mfrmls

Location Details

Township: 31

Road Surface Type: Asphalt

Property Features



Call us now

Phone: 727-888-3292

Email: RealtorCandis@gmail.com



Charles Rutenberg Realty, Inc.
THE STANDARD OF EXCELLENCE

Interior Features: Ceiling Fans(s), Eat-in Kitchen, Kitchen/Family Room Combo, L Dining, Living Room/Dining Room Combo, Solid Surface Counters, Solid Wood Cabinets, Thermostat, Walk-In Closet(s)

Flooring: Luxury Vinyl, Marble, Tile

Garage YN: Yes

Pets Allowed: Yes

Roof: Other

Water Source: Public

Cooling: Central Air

Appliances: Built-In Oven, Convection Oven, Cooktop, Dishwasher, Disposal, Dryer, Microwave, Range Hood, Refrigerator, Washer

Laundry Features: Inside

Garage Spaces: 2

Exterior Features: Balcony, Lighting

Utilities: Cable Available, Electricity Available, Water Available

Sewer: Public Sewer

Heating: Central

Property Details

Subdivision Name: SIGNATURE PLACE CONDO

Levels: One

Foundation Details: Slab

Listing Terms: Cash, Conventional

Parcel Number: 19-31-17-81887-001-3103

Direction Faces: Southeast

Construction Materials: Block, Stucco

Association Information

Association YN: Yes

Association Fee Frequency: Monthly

Association Fee Includes: Guard - 24 Hour, Cable TV, Common Area Taxes, Pool, Escrow Reserves Fund, Insurance, Internet, Maintenance Structure, Maintenance Grounds, Recreational Facilities

Community Features: Buyer Approval Required, Clubhouse, Fitness Center, Pool

Fees&Taxes



Call us now

Phone: 727-888-3292

Email: RealtorCandis@gmail.com



Charles Rutenberg Realty, Inc.
THE STANDARD OF EXCELLENCE

Tax Year: 2024

Tax Annual Amount:
\$41,121

Tax Legal Description: SIGNATURE PLACE CONDO TOWER BLDG,
UNIT 3103 TOGETHER WITH THE USE OF PARKING SPACES 186 & 187
& STORAGE UNITS 86 & 87

Tax Lot: 3103

Rooms

Room type	Dimensions	Level	Length	Width
Primary Bedroom	10x18	First	18	10
Kitchen	11x16	First	16	11
Living Room	12x21	First	21	12

Amenities & Features

Waterfront available: No

AttachedGarageYN: No

PoolPrivateYN: No

CommunityFeatures: Buyer Approval Required, Clubhouse, Fitness Center, Pool

Utilities: Cable Available, Electricity Available, Water Available

Amenities: Built-In Oven, Convection Oven, Cooktop, Dishwasher, Disposal, Dryer, Microwave, Range Hood, Refrigerator, Washer

GarageYN: Yes

FireplaceYN: No

Cooling: Central Air

ExteriorFeatures: Balcony, Lighting

Features: Ceiling Fans(s), Eat-in Kitchen, Kitchen/Family Room Combo, L Dining, Living Room/Dining Room Combo, Solid Surface Counters, Solid Wood Cabinets, Thermostat, Walk-In Closet(s)

Building Details

NewConstructionYN: No

Exterior material: Block, Stucco

Heating: Central

Roof: Other

Miscellaneous

Ownership: Condominium

Occupant Type:
Vacant

Showing Requirements: Call Listing Agent, Listing Agent Must
Accompany, ShowingTime



Call us now

Phone: 727-888-3292

Email: RealtorCandis@gmail.com



Charles Rutenberg Realty, Inc.
THE STANDARD OF EXCELLENCE