

1638 ST CATHERINE DRIVE DUNEDIN FL 34698

<https://candiscarmichael.com>

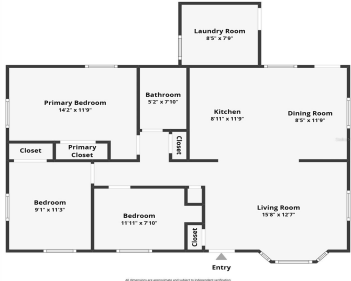

\$424,900



Captivating single-family home in Dunedin, FL. Welcome to 1638 St Catherine Dr W, a 3-bedroom, 1 bathroom home nestled in a quaint neighborhood just minutes from downtown Dunedin. This residence offers comfortable and practical living. Situated in the highly sought-after Cardinal Manor Neighborhood, you'll enjoy proximity to Clearwater beach, Honeymoon Island, Downtown Dunedin, Pinellas Trail, [...]

- 3 beds
- 1 bath
- Residential
- Single Family Residence
- Active
- 936 sq ft

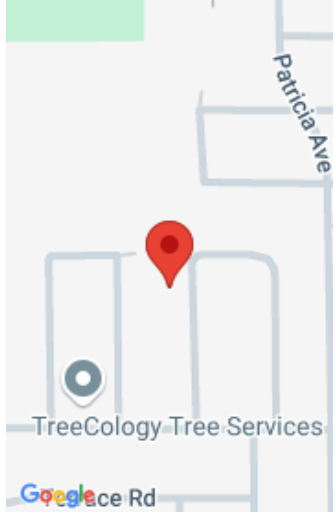

Call us now

Phone: 727-888-3292
Email: RealtorCandis@gmail.com



Courtesy of

Listing Office: CHARLES RUTENBERG REALTY INC

Status: Active

Office ID: MFR260000779

MLS ID: MFRTB8327628

Description

Virtual Tour:

https://www.zillow.com/view-imx/952eb65d-e20f-4940-81db-9a7f4393fa62?setAttribution=mls&wl=true&initialViewType=pano&utm_source=dashboard

Basics

Bathrooms Full: 1

Category: Single Family Residence

Bedrooms: 3 beds

Half baths: 0 half baths

Area, sq ft: 936 sq ft

Year built: 1971

ListOfficeName: CHARLES RUTENBERG
REALTY INC

Date added: Added 2 days ago

Type: Residential

Bathrooms: 1 bath

Floors: 1 floor

Lot size, sq ft: 7797 sq ft

SubdivisionName: CARDINAL MANOR 1ST
ADD

ListAOR: mfrmls

Location Details

Township: 28

Elementary School: San Jose Elementary-PN

High School: Dunedin High-PN

Road Surface Type: Paved

Middle Or Junior School: Palm Harbor Middle-
PN

Property Features



Call us now

Phone: 727-888-3292

Email: RealtorCandis@gmail.com



Charles Rutenberg Realty, Inc.
THE STANDARD OF EXCELLENCE

Interior Features: Ceiling Fans(s), Eat-in Kitchen, Living Room/Dining Room Combo, Stone Counters, Thermostat

Flooring: Vinyl

Patio And Porch Features: Covered, Front Porch

Pets Allowed: Yes

Fencing: Fenced

Window Features: ENERGY STAR Qualified Windows, Impact Glass/Storm Windows, Insulated Windows

Utilities: Cable Available, Electricity Available, Sewer Available

Water Source: Public

Cooling: Central Air

Furnished: Unfurnished

Appliances: Microwave, Range, Refrigerator

Laundry Features: Laundry Room

Parking Features: Driveway

Exterior Features: Lighting, Private Mailbox, Rain Gutters, Storage

Roof: Shingle

Architectural Style: Traditional

Vegetation: Mature Landscaping, Oak Trees, Trees/Landscaped

Sewer: Public Sewer

Heating: Central, Natural Gas

Lot Features: City Limits, Near Golf Course, Near Marina, Near Public Transit, Paved

Property Details

Subdivision Name: CARDINAL MANOR 1ST ADD

Levels: One

Foundation Details: Crawlspace

Listing Terms: Cash, Conventional, FHA, VA Loan

Parcel Number: 23-28-15-13428-000-0420

Direction Faces: East

Construction Materials: Stucco, Wood Frame

Property Condition: Completed

Fees&Taxes

Tax Year: 2023

Tax Legal Description: CARDINAL MANOR 1ST ADD LOT 42

Tax Annual Amount: \$833

Tax Lot: 42

Rooms



Call us now

Phone: 727-888-3292

Email: RealtorCandis@gmail.com



Charles Rutenberg Realty, Inc.
THE STANDARD OF EXCELLENCE

Room type	Dimensions	Level	Length	Width
Living Room	16x13	First	13	16
Kitchen	9x12	First	12	9
Dining Room	8x12	First	12	8
Bedroom 1	12x8	First	8	12
Bedroom 2	9x11	First	11	9
Primary Bedroom	14x12	First	12	14
Bathroom 1	5x8	First	8	5
Laundry	8x8	First	8	8

Amenities & Features

Waterfront available: No

AttachedGarageYN: No

PoolPrivateYN: No

WindowFeatures: ENERGY STAR Qualified Windows, Impact Glass/Storm Windows, Insulated Windows

Utilities: Cable Available, Electricity Available, Sewer Available

Amenities: Microwave, Range, Refrigerator

GarageYN: No

FireplaceYN: No

Cooling: Central Air

ExteriorFeatures: Lighting, Private Mailbox, Rain Gutters, Storage

Features: Ceiling Fans(s), Eat-in Kitchen, Living Room/Dining Room Combo, Stone Counters, Thermostat



Call us now

Phone: 727-888-3292

Email: RealtorCandis@gmail.com



Charles Rutenberg Realty, Inc.
THE STANDARD OF EXCELLENCE

Building Details

ArchitecturalStyle: Traditional

Heating: Central, Natural Gas

Roof: Shingle

NewConstructionYN: No

Exterior material: Stucco, Wood Frame

Parking: Driveway

Miscellaneous

Ownership: Fee Simple

Occupant Type: Owner

Other Structures: Shed(s) **Showing Requirements:** Appointment Only, Call Listing Agent 2, Lock Box Electronic-CBS Code Required, See Remarks, ShowingTime



Call us now

Phone: 727-888-3292

Email: RealtorCandis@gmail.com



Charles Rutenberg Realty, Inc.
THE STANDARD OF EXCELLENCE