

15822 REDINGTON DRIVE REDINGTON BEACH FL 33708

<https://candiscarmichael.com>

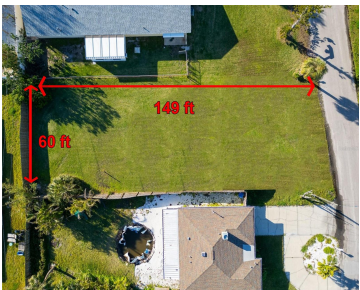

In the heart of Redington Beach! This premium-sized 8,803 sqft lot offers a rare opportunity in a neighborhood rapidly evolving with luxury development. The owner DID NOT receive a letter from FEMA — the existing structure was affected by the storm — so you have the option to tear down, build up, or put the [...]

- 2 beds
- 2 baths
- Residential
- Single Family Residence
- Active
- 1098 sq ft



Courtesy of

**Listing Office:** BHHS FLORIDA PROPERTIES GROUP

**Status:** Active

**Office ID:** MFR260017433

**MLS ID:** MFRTB8359519



Call us now

Phone: 727-888-3292  
Email: [RealtorCandis@gmail.com](mailto:RealtorCandis@gmail.com)



---

## Description

**Virtual Tour:** <https://www.propertypanorama.com/instaview/stellar/TB8359519>

---

## Basics

**Bathrooms Full:** 2

**Category:** Single Family Residence

**Bedrooms:** 2 beds

**Half baths:** 0 half baths

**Area, sq ft:** 1098 sq ft

**Year built:** 1946

**SubdivisionName:** LONE PALM BEACH 2ND  
ADD

**GarageSpaces:** 1

**Date added:** Added 4 months ago

**Type:** Residential

**Bathrooms:** 2 baths

**Floors:** 1 floor

**Lot size, sq ft:** 8803 sq ft

**View:** Water

**ListOfficeName:** BHHS FLORIDA  
PROPERTIES GROUP

**ListAOR:** mfrmls

---

## Location Details

**Township:** 31

**Road Surface Type:** Asphalt

**Elementary School:** Bauder Elementary-PN **Middle Or Junior School:** Seminole Middle-PN

**High School:** Seminole High-PN

---

## Property Features



**Call us now**

Phone: 727-888-3292

Email: [RealtorCandis@gmail.com](mailto:RealtorCandis@gmail.com)



Charles Rutenberg Realty, Inc.  
THE STANDARD OF EXCELLENCE

**Interior Features:** Kitchen/Family Room Combo  
**Flooring:** Laminate  
**Garage YN:** Yes  
**Garage Spaces:** 1  
**Exterior Features:** Private Mailbox  
**Utilities:** Other  
**Water Source:** Public  
**Cooling:** Central Air  
**Furnished:** Unfurnished  
**Appliances:** None  
**Laundry Features:** None  
**Attached Garage YN:** Yes  
**Pets Allowed:** Yes  
**Roof:** Shingle  
**View:** Water  
**Sewer:** Public Sewer  
**Heating:** Central  
**Lot Features:** Flood Insurance Required, FloodZone

---

## Property Details

**Subdivision Name:** LONE PALM BEACH 2ND ADD  
**Levels:** One  
**Foundation Details:** Other  
**Listing Terms:** Cash  
**Parcel Number:** 04-31-15-52560-017-0130  
**Direction Faces:** Northeast  
**Construction Materials:** Block, Stucco

---

## Fees&Taxes

**Tax Year:** 2024  
**Tax Annual Amount:** \$6,500  
**Tax Legal Description:** LONE PALM BEACH 2ND ADD BLK 17, LOT 13  
**Tax Lot:** 13

---

## Rooms



**Call us now**

Phone: 727-888-3292

Email: [RealtorCandis@gmail.com](mailto:RealtorCandis@gmail.com)



Room type	Level
Great Room	First
Kitchen	First
Primary Bedroom	First

## Amenities & Features

**Waterfront available:** No

**AttachedGarageYN:** Yes

**PoolPrivateYN:** No

**ExteriorFeatures:** Private Mailbox

**Features:** Kitchen/Family Room Combo

**GarageYN:** Yes

**FireplaceYN:** No

**Cooling:** Central Air

**Utilities:** Other

**Amenities:** None

## Building Details

**NewConstructionYN:** No

**Exterior material:** Block, Stucco

**Heating:** Central

**Roof:** Shingle

## Miscellaneous

**Ownership:** Fee Simple

**Occupant Type:** Vacant

**Showing Requirements:** Call Before Showing, Call Listing Agent



**Call us now**

Phone: 727-888-3292

Email: RealtorCandis@gmail.com

